



WATER PRESSURE SENSOR

116CP Series

WORLD CLASS PERFORMANCE

Utilizing Sensata's industry leading ceramic capacitive technology, the 116CP is housed in a small and innovative plastic package ideal for boilers, pumps, and other light industrial applications.

The 116CP is offered in a wide range of configurations including various pressure ports, electrical outs and pressure ranges from 0-3 to 0-16 bar.

Features

- Multiple port & Connector options
- High accuracy: +/-1.5%FS
- Small & compact size
- 100% automated calibration
- REACH/RoHS compliant

Applications

- Boilers
- Heat pumps
- Residential booster pumps
- Lawn & Pool pumps
- Circulator pumps
- Pump controllers
- Food & Beverage equipment

Technical Specifications

Pressure Ranges

0-3 to 0-16bar

Performance

Electrical Connection RAST 2.5
 Pressure Connection..... G $\frac{3}{8}$, G $\frac{1}{4}$, quick connect
 (See next page drawings)
 Pressure Reference..... Sealed Gauge (1bar)
 Total Error Band Accuracy..... +/-1.5%FS (typical)
 Operating Temperature 2° to 90°C
 Storage Temperature -40° to 125°C

Electrical

Supply Voltage 5VDC or 8-30VDC
 Output Voltage..... 0.5 to 3.5V
 Supply Current 8.0mA
 Output Current 5.0mA (max)
 Output Load 10kOhm pull down
 Output Response Time <10ms
 Overvoltage Protection 16V
 Reverse Voltage -14V
 Short Circuit Protected Yes
 EMC Conforms to EN 61326-2-3 for sensors
 ESD..... 8kV/air, 4kV/direct

Physical

Proof Pressure..... 2xFS (1)
 Burst Pressure 3xFS (1)
 Random Vibration 5G (2-2kHz)
 Mechanical Shock 40G $\frac{1}{2}$ HL SINE
 Drop (any Axis) 1m

Agencies

REACH
 RoHS compliant
 CE

Note:

(1) FS (Pressure) = $P_{max} - P_{min}$
 FS (Voltage) = $V_{out_{max}} - V_{out_{min}}$

WATER PRESSURE SENSOR

116CP Series

Dimensions All dimensions are in millimeters (mm)

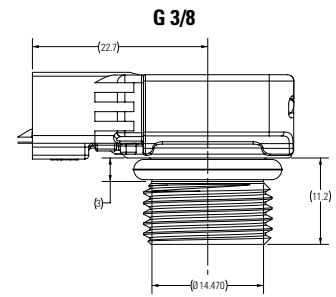
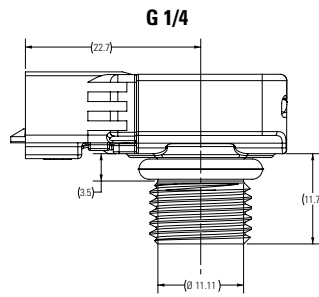
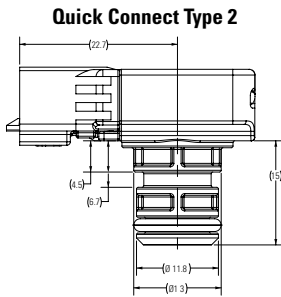
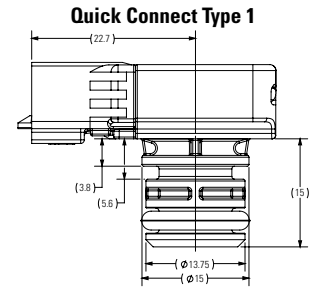
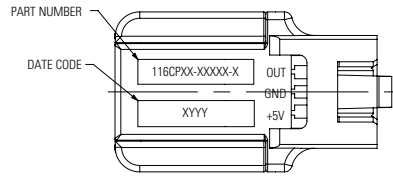
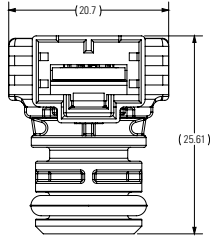

Ordering Information

EXAMPLE			116		CP		2		1		-	M04		S		2		-	0
Input																			
116	(5VDC)																		
117	(8-30VDC)																		
Family																			
CP	Ceramic Capacitive Pressure (APT)																		
Port																			
1	(Null)																		
2	(Quick Connect Type 1)																		
3	(G ¹ / ₄)																		
4	(G ³ / ₈)																		
5	(Quick Connect Type 2)																		
Connector																			
0	(Null)																		
1	(RAST 2.5 3Pos)																		
2	(RAST 2.5 4Pos)																		
3	(RAST 2.5 3Pos Alternate)																		
Pressure																			
Bar	PSI																		
M06	090																		
M10	150																		
M16	230																		
MXX	YYY																		
P_ref																			
A	(Absolute)																		
S	(Sealed Gauge)																		
G	(Gauge)																		
Span																			
1	(1.125-3.6V)																		
2	(0.5-3.5V)																		
3	(0.5-4.5V)																		
4	(0.5-2.75V)																		
5	(0.5-2.5V)																		
6	(Custom)																		
Special Requirement																			
0 or 50	(Application Dependent)																		
1	(Custom)																		



The World Depends on Sensors and Controls

Americas
 +1 (800) 350 2727 – Option 4
 sensors@sensata.com
 switches@sensata.com

Europe, Middle East & Africa
 +359 (2) 809 1826
 pressure-info.eu@sensata.com

Asia Pacific
 sales.isasia@list.sensata.com

China
 +86 (21) 2306 1500

Japan
 +81 (45) 277 7117

Korea
 +82 (31) 601 2004

India
 +91 (80) 67920890

Rest of Asia
 +886 (2) 27602006 ext 2808

Important Notice: Sensata Technologies (Sensata) reserves the right to make changes to or discontinue any product or service identified in this publication without notice. Sensata advises its customers to obtain the latest version of the relevant information to verify, before placing any orders, that the information being relied upon is current. Sensata assumes no responsibility for infringement of patents or rights of others based on Sensata applications assistance or product specifications since Sensata does not possess full access concerning the use or application of customers' products. Sensata also assumes no responsibility for customers' product designs.

www.sensata.com

Printed in U.S.A., 04/2017